

BLADE 230 S Titanium Main Shaft/CNC Delrin Main Gear/Auto-Rotation Hub set INSTRUCTION

MICROHELI CO., LTD.

COPYRIGHT © 2017 MICROHELI®

1

TITANIUM MAIN SHAFT/CNC DELRIN MAIN GEAR W/ AUTO-ROTATION HUB SET MH-230S067X



Apply Loctite to all screws

0.8x5.2mm Stainless Steel Pin

M1x3mm Phillips Head Screw

4x8x6mm Oneway Bearing

.....x1

.....x6

.....x1

M1x2mm Phillips Head Screw

4x8x0.5mm Brass Bushing

.....x3

.....x2

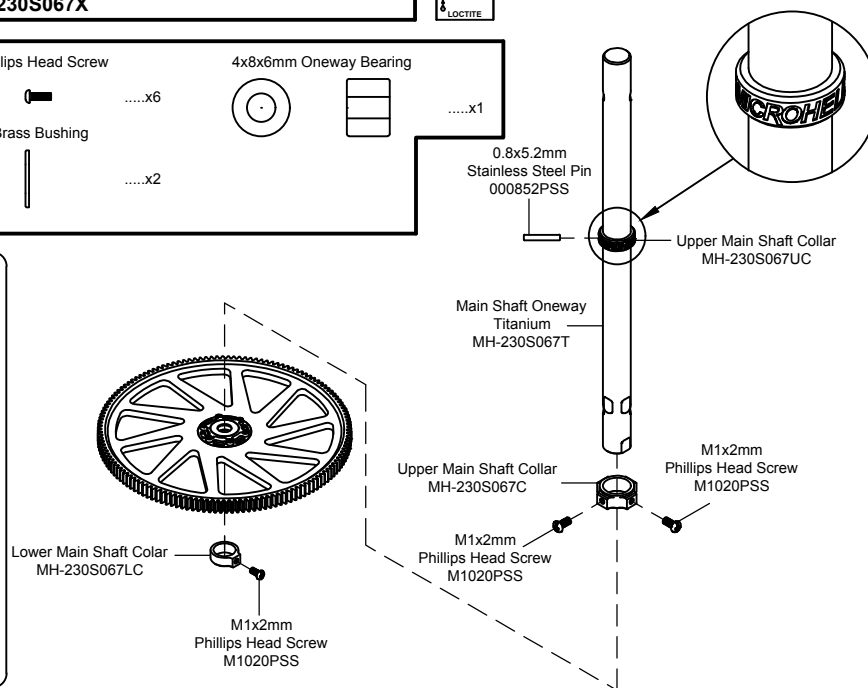
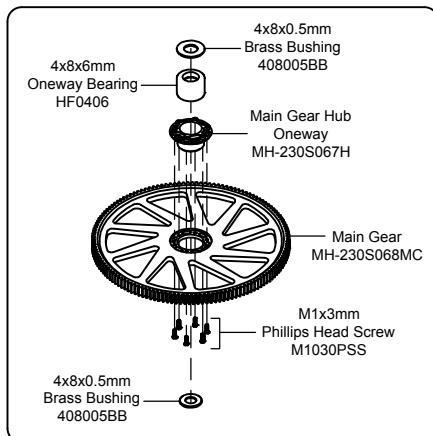

Apply Loctite

CAUTION: Please check your model helicopter carefully before attempt to fly!

REV. 230S067X-241115-01

01