

BLADE 230 S HELICOPTER CNC Solid Carbon Main Shaft/Collar set INSTRUCTION

MICROHELI CO., LTD.

COPYRIGHT © 2017 MICROHELI®

1

CNC SOLID CARBON MAIN SHAFT/COLAR SET MH-230S066C



Apply Loctite to all screws

M1x2mm Phillips Head Screw



.....x2

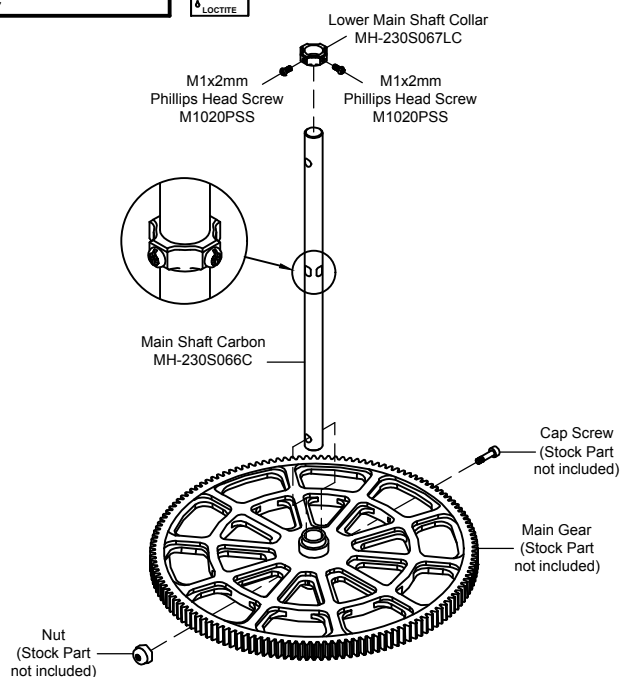

Apply Loctite

CAUTION: Please check your model helicopter carefully before attempt to fly!

REV. 230S066C-210915-01

01