

# BLADE 230 S HELICOPTER Precision CNC Aluminum Main Rotor Hub INSTRUCTION

MICROHELI CO., LTD.

COPYRIGHT © 2017 MICROHELI®

1

## PRECISION CNC ALUMINUM MAIN ROTOR HUB W/ BUTTON MH-230S001

M1.6x5mm Phillips Head Screw



.....X1

M2x8mm Cap Screw



.....X1



Apply Loctite to all screws

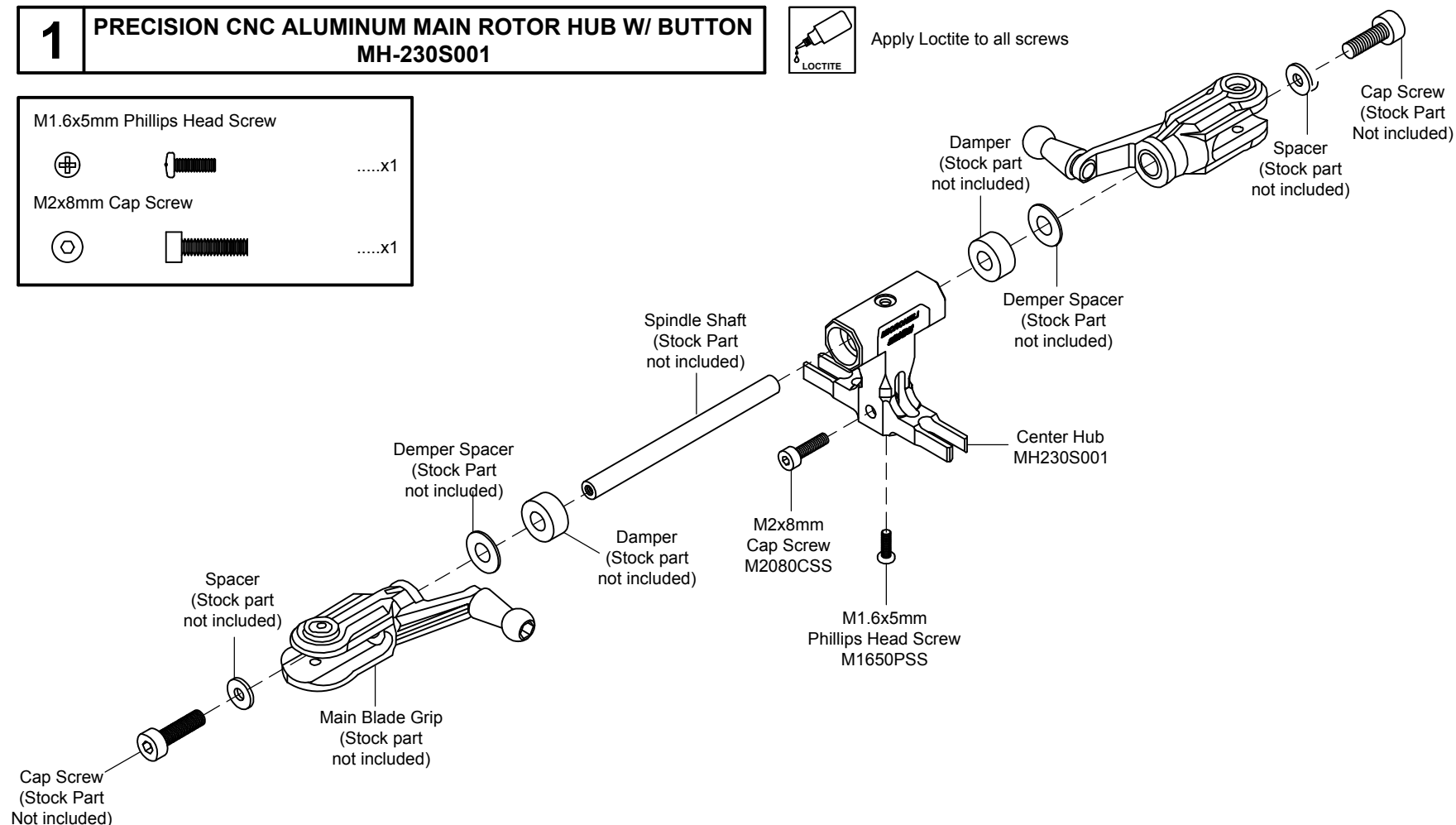

Apply Loctite

**CAUTION: Please check your model helicopter carefully before attempt to fly!**

REV. 230S001-121015-01