

BLADE 180CFX HELICOPTER Precision CNC Solid Titanium Main Shaft/Collar set INSTRUCTION

MICROHELI CO., LTD.

COPYRIGHT © 2017 MICROHELI®

1

PRECISION CNC SOLID TITANIUM MAIN SHAFT/COLLAR SET MH-18FX066T



Apply Loctite to all screws

0.8x5.2mm Stainless Steel Pin

.....X1

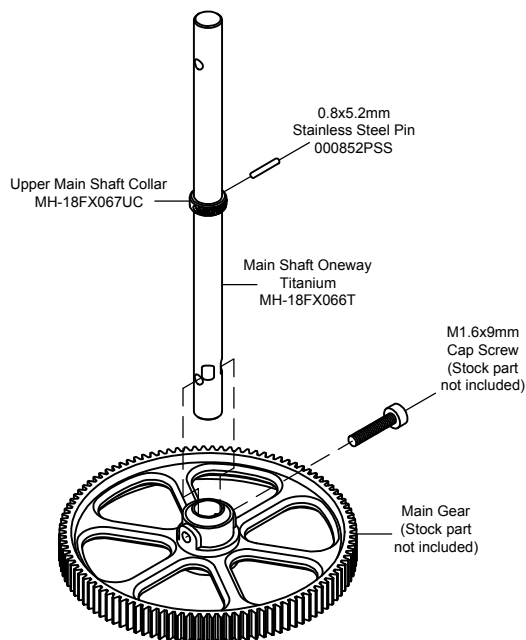

Compatible with Main Gear Stock

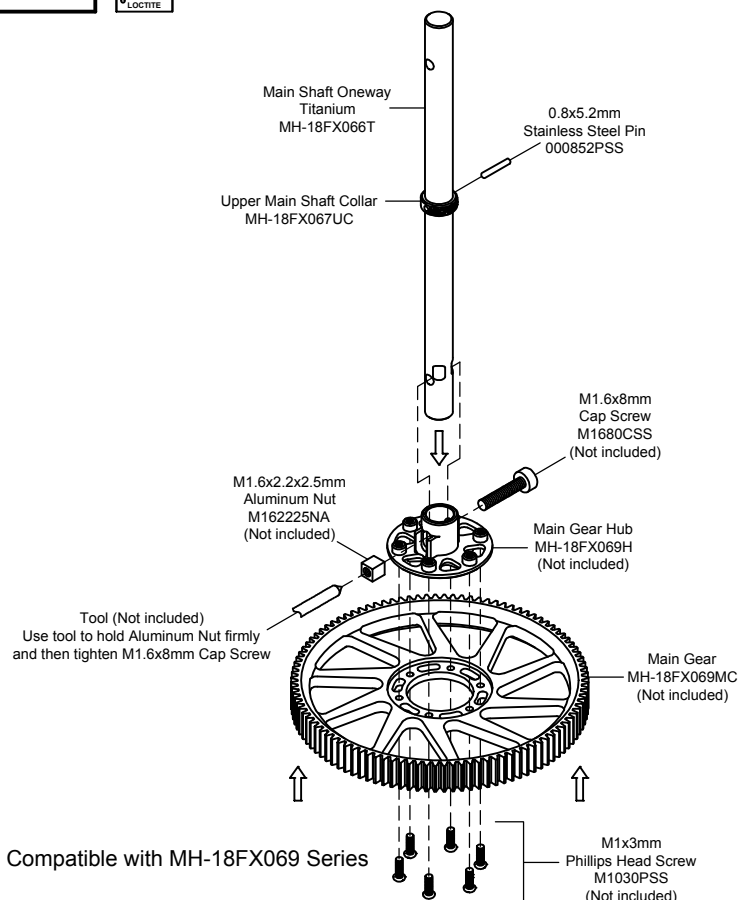

Compatible with MH-18FX069 Series

Compatible with MH-18FX067 Series

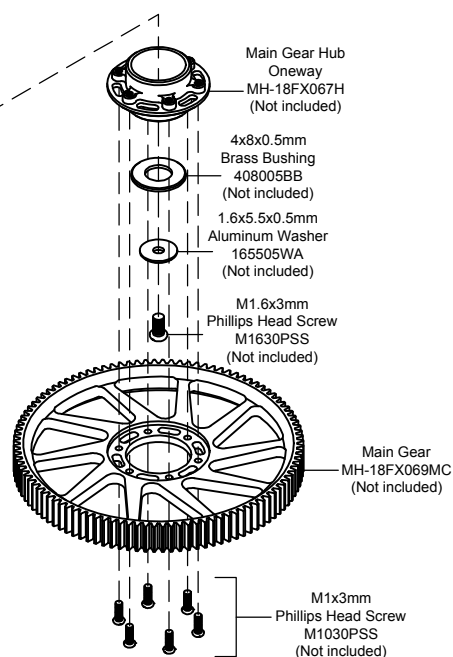
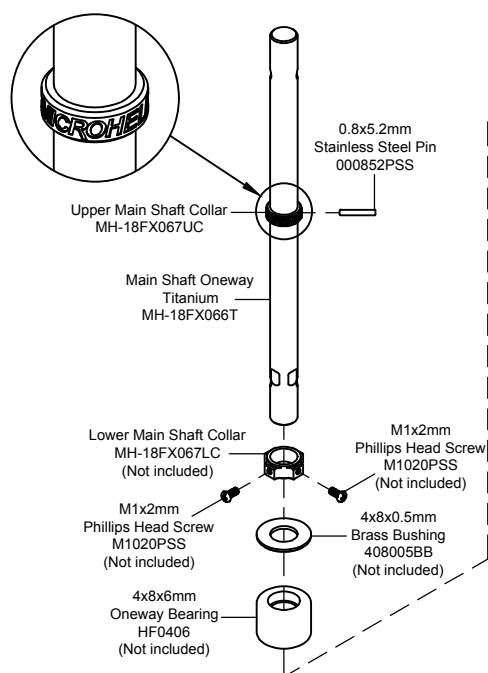

Apply Loctite

CAUTION: Please check your model helicopter carefully before attempt to fly!

REV. 18FX066T-200115-01