

BLADE 180 CFX HELICOPTER 7075 Aluminum Motor Mount INSTRUCTION

MICROHELI CO., LTD.

COPYRIGHT © 2017 MICROHELI®

1

7075 ALUMINUM MOTOR MOUNT MH-18FX005MM



Apply Loctite to all screws

M1.6x4mm Cap Screw



.....x4

M1.6mm Aluminum Counterbore Washer



.....x4

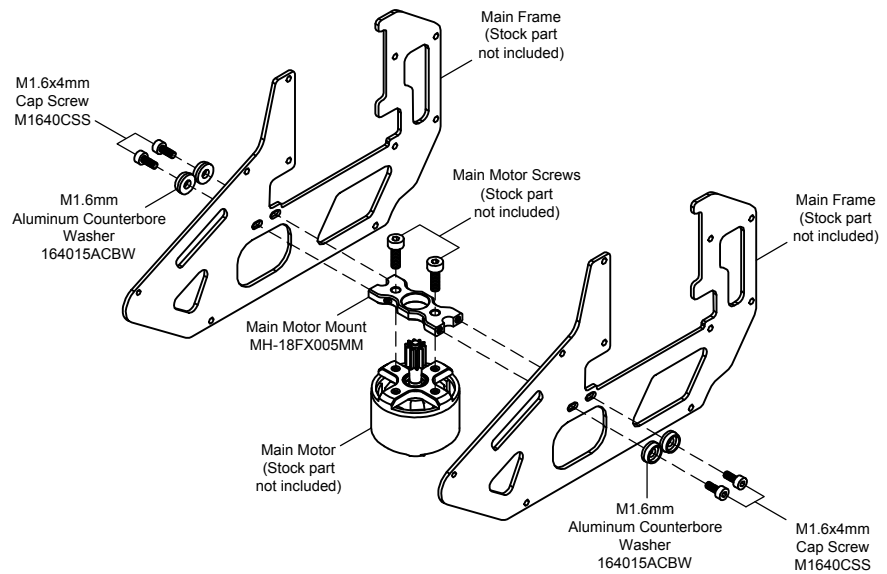

Apply Loctite

CAUTION: Please check your model helicopter carefully before attempt to fly!

REV: 18FX005MM-050315-01

01