

# BLADE 180 CFX HELICOPTER Aluminum/Carbon Fiber Main Frame INSTRUCTION

MICROHELI CO., LTD.

COPYRIGHT © 2017 MICROHELI®

3

## ALUMINUM/CARBON FIBER MAIN FRAME MH-18FX005



Apply Loctite to all screws

M1.6x4mm Cap Screw

.....x8

M1.6x4mm Phillips Head Screw

.....x7

M1.6x6mm Phillips Head Screw

.....x1

5x6.5x1mm Brass Spacer

.....x1

2.5x6x1.8mm Radial Bearing

.....x2

5x8x2mm Radial Bearing

.....x2

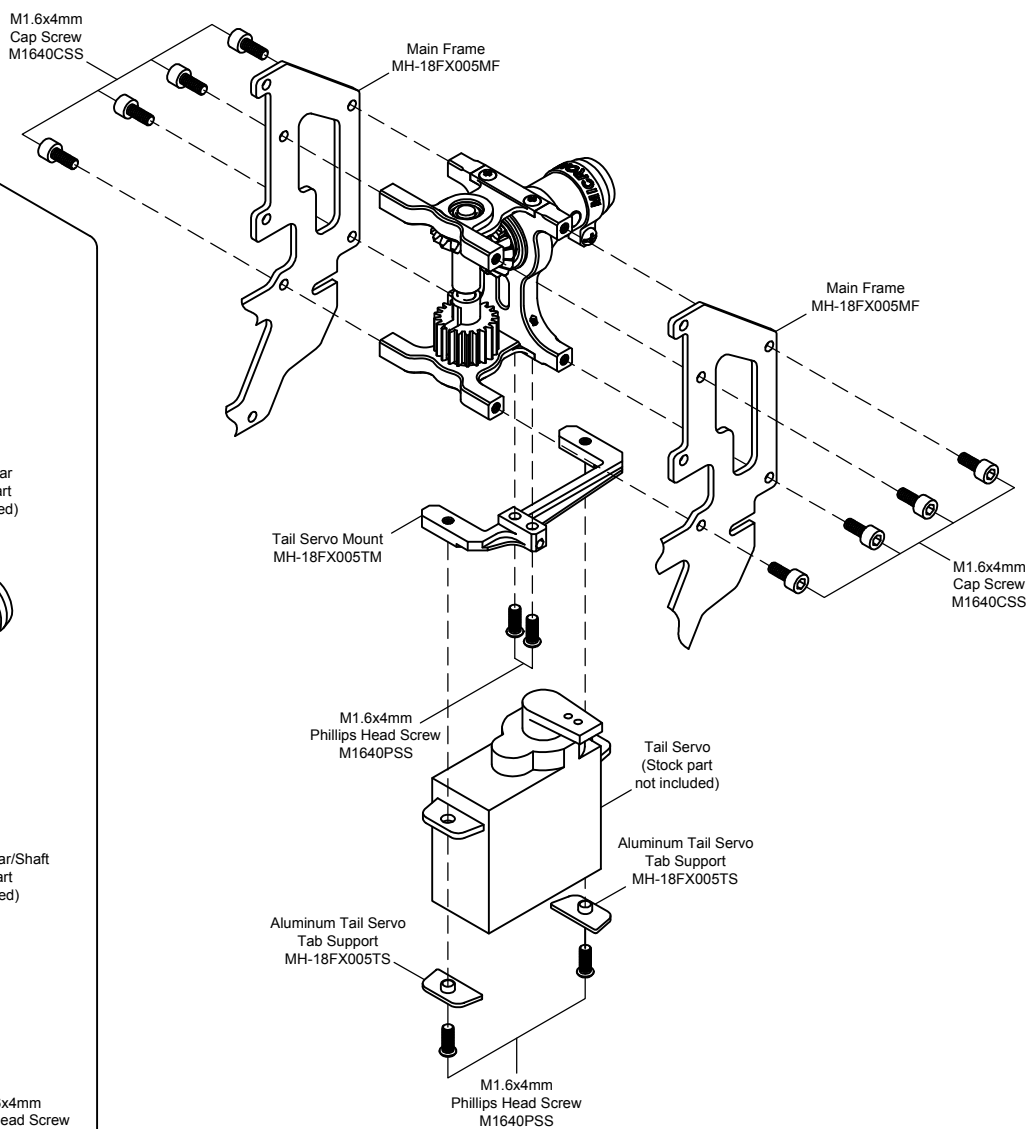
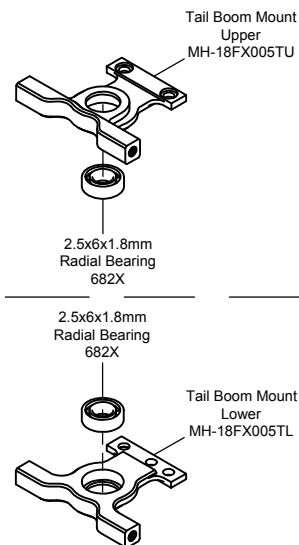
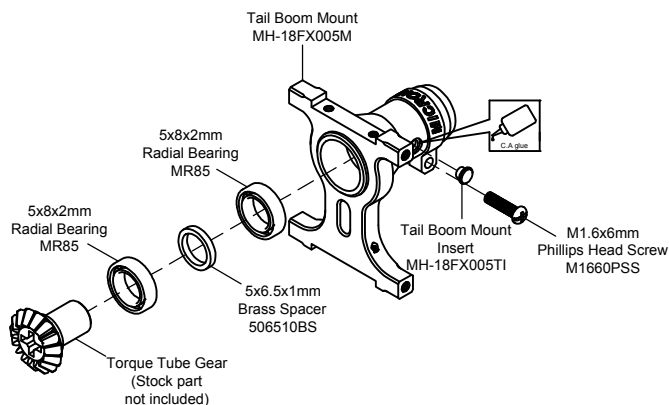

M1.6x4mm  
Phillips Head Screw  
M1640PSS

Bevel Gear  
(Stock part  
not included)

Tail Pinion Gear/Shaft  
(Stock part  
not included)

M1.6x4mm  
Phillips Head Screw  
M1640PSS



Apply Loctite



Apply C.A. glue

**CAUTION: Please check your model helicopter carefully before attempt to fly!**

REV. 18FX005-090315-01