

## BLADE 180 CFX HELICOPTER CNC Blade 180 CFX Tail Power package INSTRUCTION

MICROHELI CO., LTD.

COPYRIGHT © 2017 MICROHELI®

**5**

### CNC BLADE 180 CFX TAIL POWER PACKAGE MH-18FX-TPWW



Apply Loctite to all screws

1.4x2.5x0.3mm Stainless Steel Washer

M1.4x3mm Phillips Head Screw

.....X2

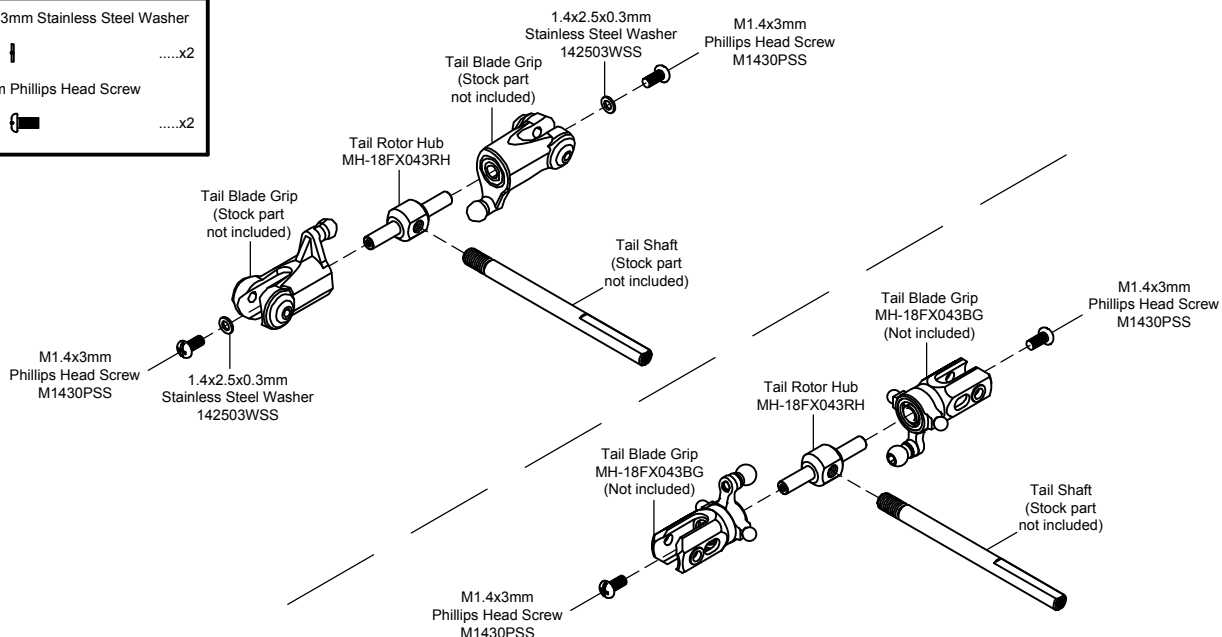

Apply Loctite

**CAUTION: Please check your model helicopter carefully before attempt to fly!**

REV. 18FX-TPWW-100315-01

**05**

## BLADE 180 CFX HELICOPTER CNC Blade 180 CFX Tail Power package INSTRUCTION

MICROHELI CO., LTD.

COPYRIGHT © 2017 MICROHELI®

**6**

### CNC BLADE 180 CFX TAIL POWER PACKAGE MH-18FX-TPWW



Apply Loctite to all screws

1.6x3.5x0.3mm Stainless Steel Washer

.....X1

2.5x4x0.3mm Brass Spacer

.....X1

M1.6x4mm Cap Screw

.....X1

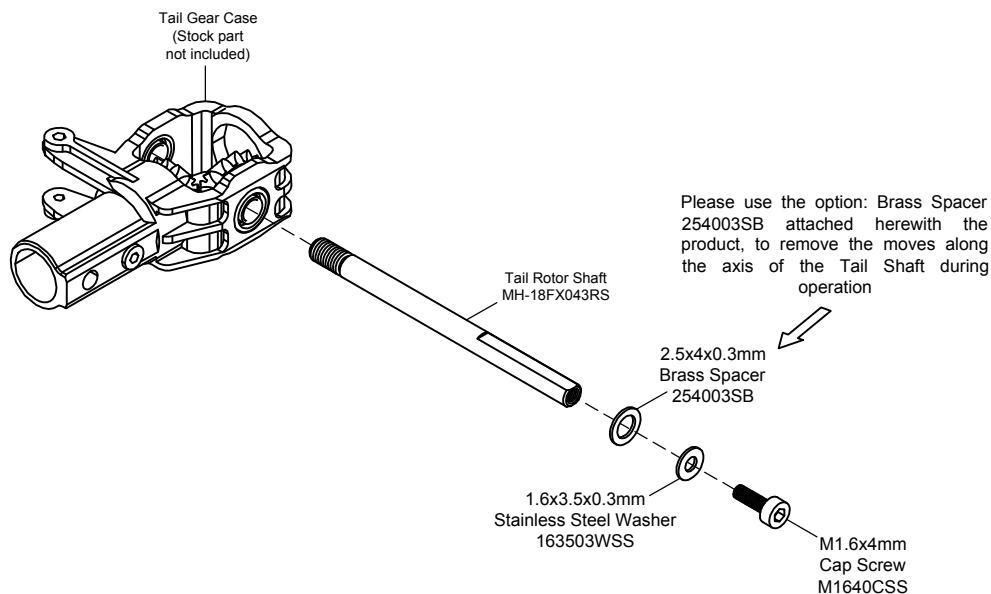

Apply Loctite

**CAUTION: Please check your model helicopter carefully before attempt to fly!**

REV. 18FX-TPWW-100315-01

**06**