

BLADE 180 CFX CNC Blade 180 CFX Performance combo package INSTRUCTION

MICROHELI CO., LTD.

COPYRIGHT © 2017 MICROHELI®

19 ALUMINUM/CARBON FIBER MAIN FRAME MH-18FX005



Apply Loctite to all screws

- M1.6x4mm Cap Screwx8
- M1.6x4mm Phillips Head Screwx7
- M1.6x6mm Phillips Head Screwx1
- 5x6.5x1mm Brass Spacerx1
- 2.5x6x1.8mm Radial Bearingx2
- 5x8x2mm Radial Bearingx2

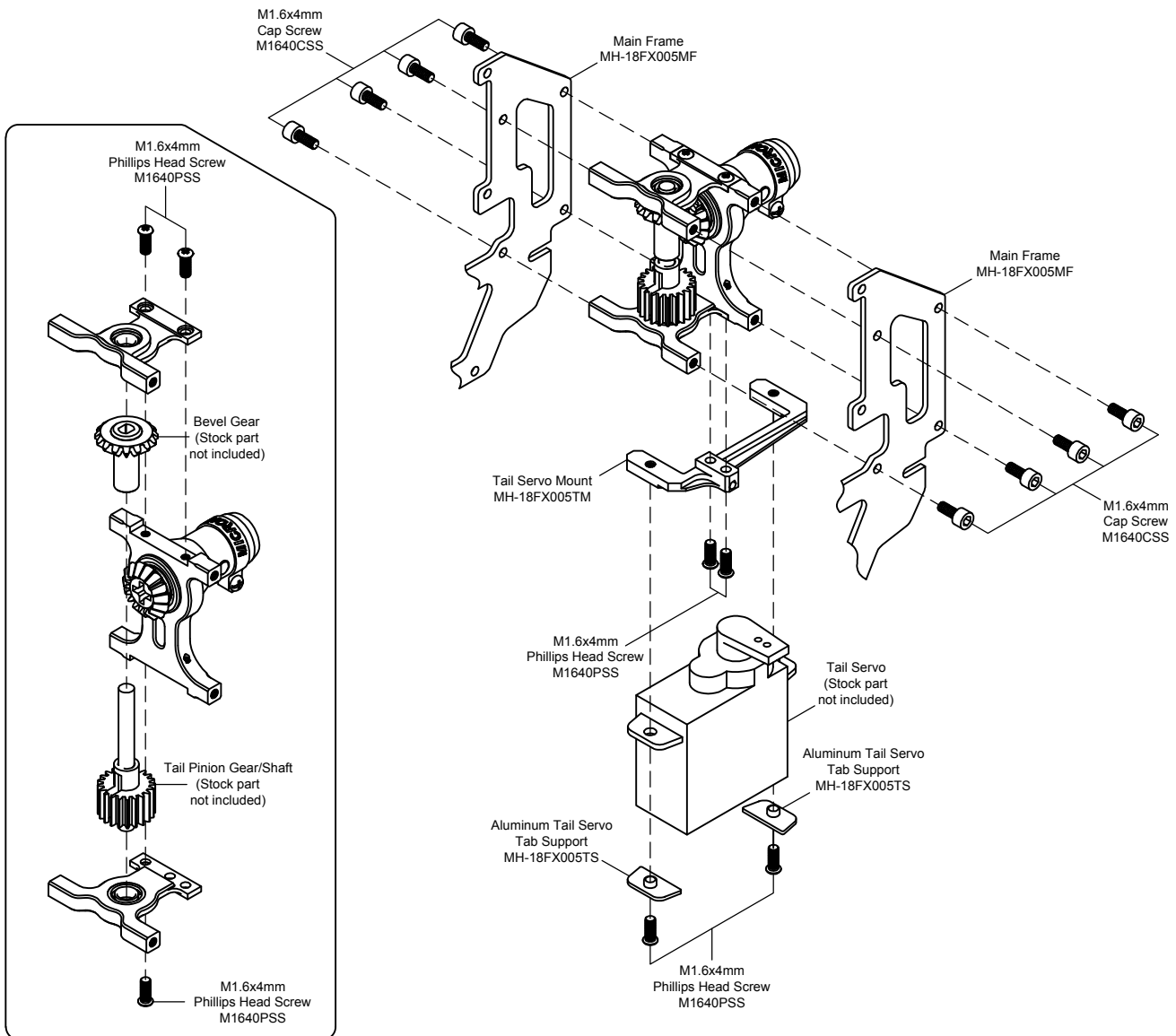
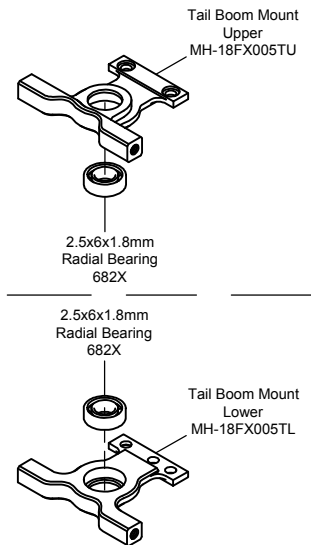
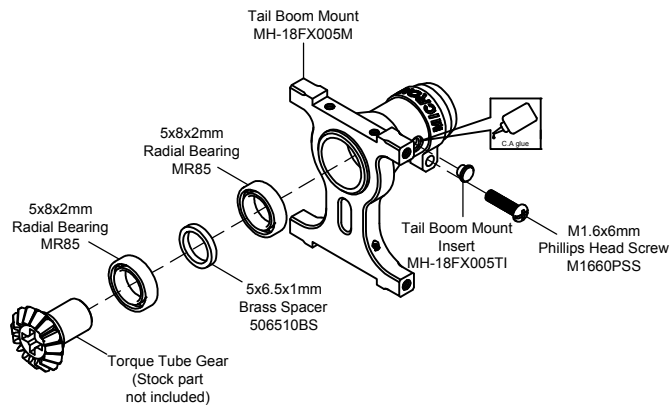

Apply Loctite



Apply C.A. glue

CAUTION: Please check your model helicopter carefully before attempt to fly!

REV. 18FX-PFCW-250817-01