

BLADE 180 CFX CNC Blade 180 CFX Performance combo package INSTRUCTION

MICROHELI CO., LTD.

COPYRIGHT © 2017 MICROHELI®

1 PRECISION CNC ALUMINUM MAIN ROTOR HUB W/ BUTTON MH-18FX001B



Apply Loctite to all screws

M1.2x3mm Phillips Head Screw

.....x1

M1.6x6mm Phillips Head Screw

.....x1

2.5x5.5x0.4mm Brass Spacer

.....x2

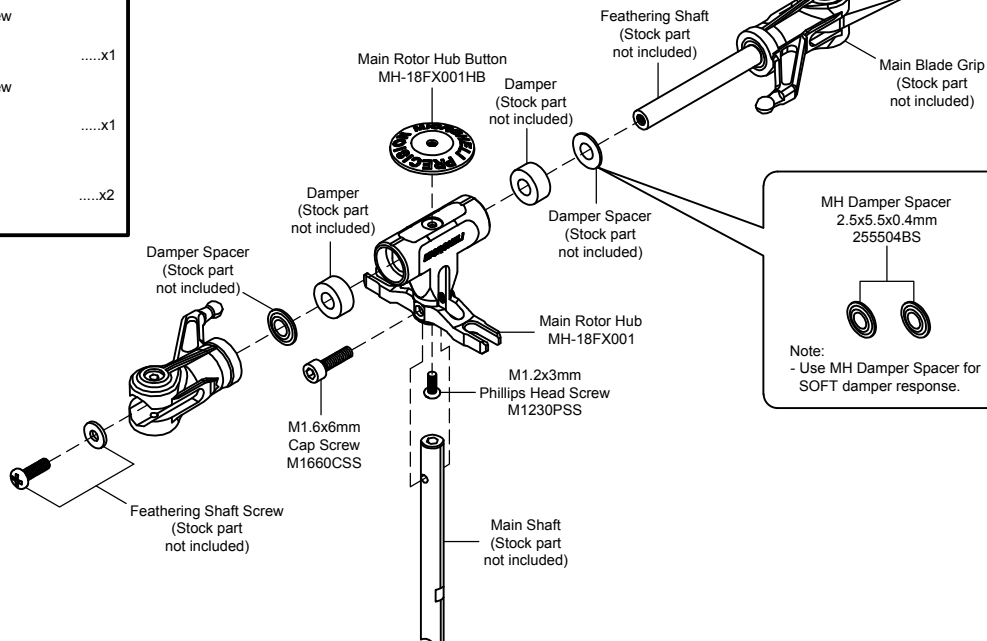

MH Damper Spacer
2.5x5.5x0.4mm
255504BS

Note:
- Use MH Damper Spacer for
SOFT damper response.



Apply Loctite

CAUTION: Please check your model helicopter carefully before attempt to fly!

REV. 18FX-PFCW-250817-01

01

BLADE 180 CFX CNC Blade 180 CFX Performance combo package INSTRUCTION

MICROHELI CO., LTD.

COPYRIGHT © 2017 MICROHELI®

2 MAIN BLADE GRIP W/ THRUST BEARING/TITANIUM BALL MH-18FX002



Apply Loctite to all screws

3mm Titanium Ball

.....x2

2.5x5.5x0.6mm Brass Spacer

.....x2

2.5x6x1.8mm Radial Bearing

.....x4

2.5x4.5x1.1mm Aluminum Spacer

.....x2

2.5x5.5x0.7mm Brass Spacer

.....x2

2.5x6x3mm Thrust Bearing

.....x2

M1.6x8mm Cap Screw

.....x2

Feathering Shaft Screw
(Stock part
not included)

M1.6x8mm
Cap Screw
M1680CSS

Damping setting:
-Use Damper Spacer 2.5x5.5x0.6mm
set for 3D fly.
-Use Damper Spacer 2.5x5.5x0.7mm
set for EXTREME 3D fly.

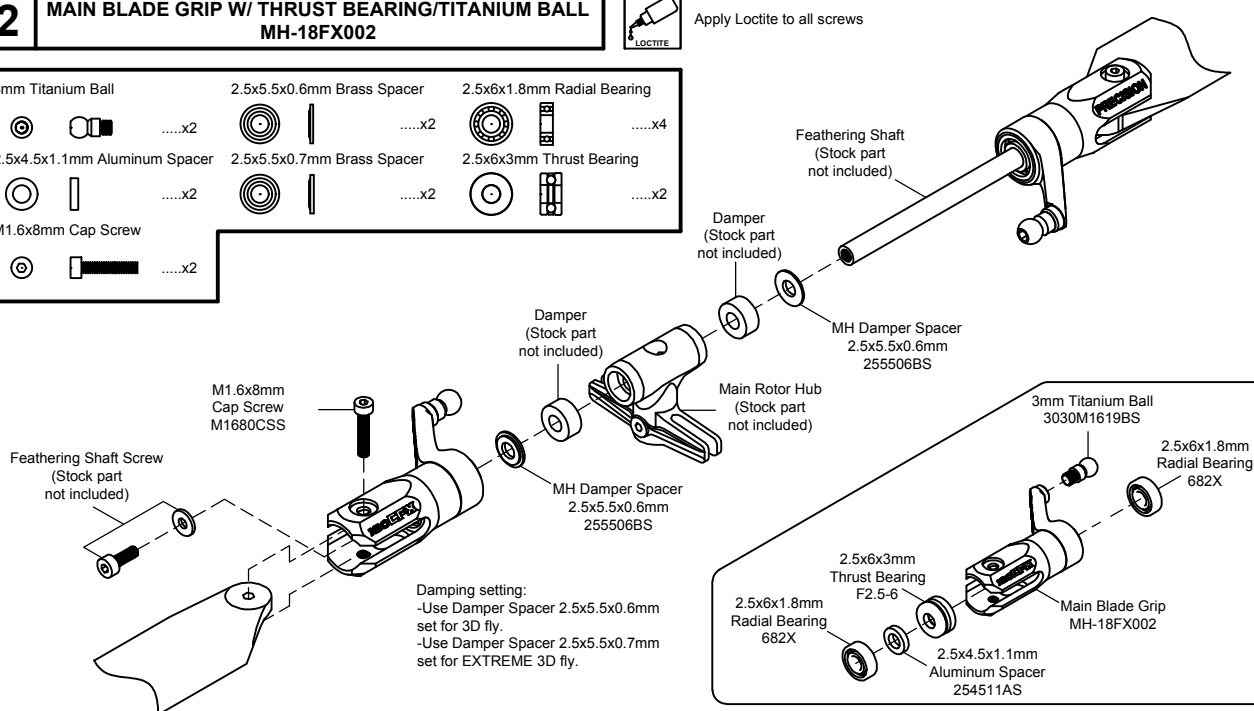

3mm Titanium Ball
3030M1619BS

2.5x6x1.8mm
Radial Bearing
682X

2.5x6x3mm
Thrust Bearing
F2.5-6

2.5x6x1.8mm
Radial Bearing
682X

2.5x4.5x1.1mm
Aluminum Spacer
254511AS



Apply Loctite

CAUTION: Please check your model helicopter carefully before attempt to fly!

REV. 18FX-PFCW-250817-01

01