

# BLADE 130 S HELICOPTER Precision CNC Aluminum Main Rotor Hub w/ Button INSTRUCTION

MICROHELI CO., LTD.

COPYRIGHT © 2017 MICROHELI®

1

## PRECISION CNC ALUMINUM MAIN ROTOR HUB W/ BUTTON MH-130S001B



Apply Loctite to all screws

M1.2x3mm Phillips Head Screw



.....x1

M1.6x6mm Cap Screw



.....x1

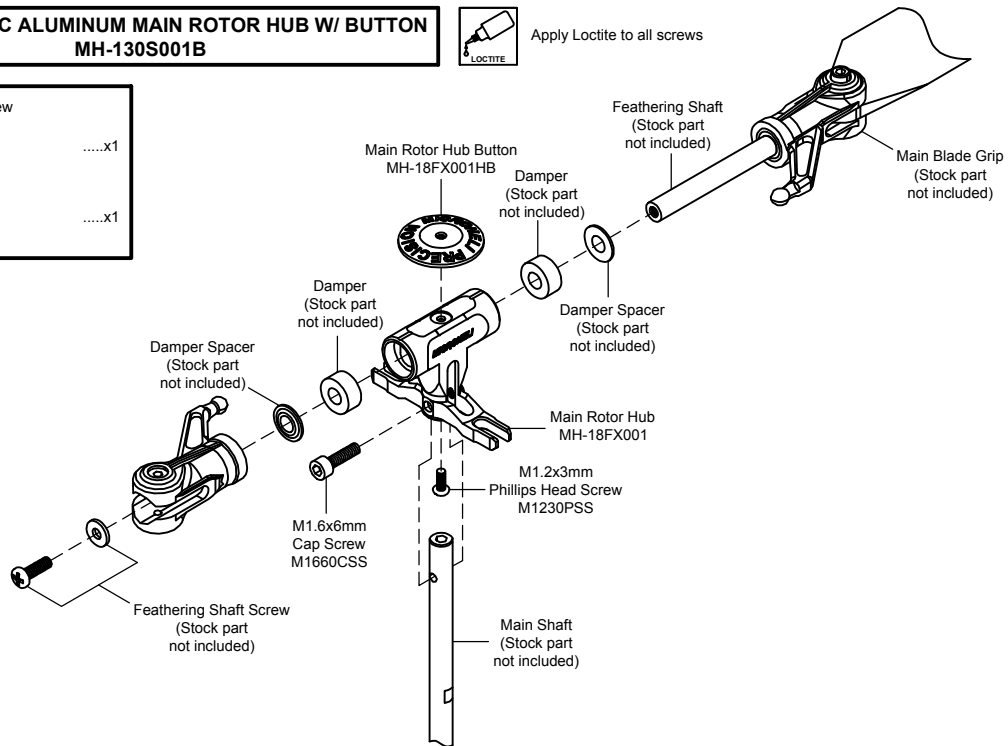

Apply Loctite

**CAUTION: Please check your model helicopter carefully before attempt to fly!**

REV: 130S001B-230817-02

01