

BLADE 130 S HELICOPTER Precision CNC Aluminum Main Rotor Hub INSTRUCTION

MICROHELI CO., LTD.

COPYRIGHT © 2017 MICROHELI®

1

PRECISION CNC ALUMINUM MAIN ROTOR HUB MH-130S001



Apply Loctite to all screws

M1.6x6mm Cap Screw



.....x1

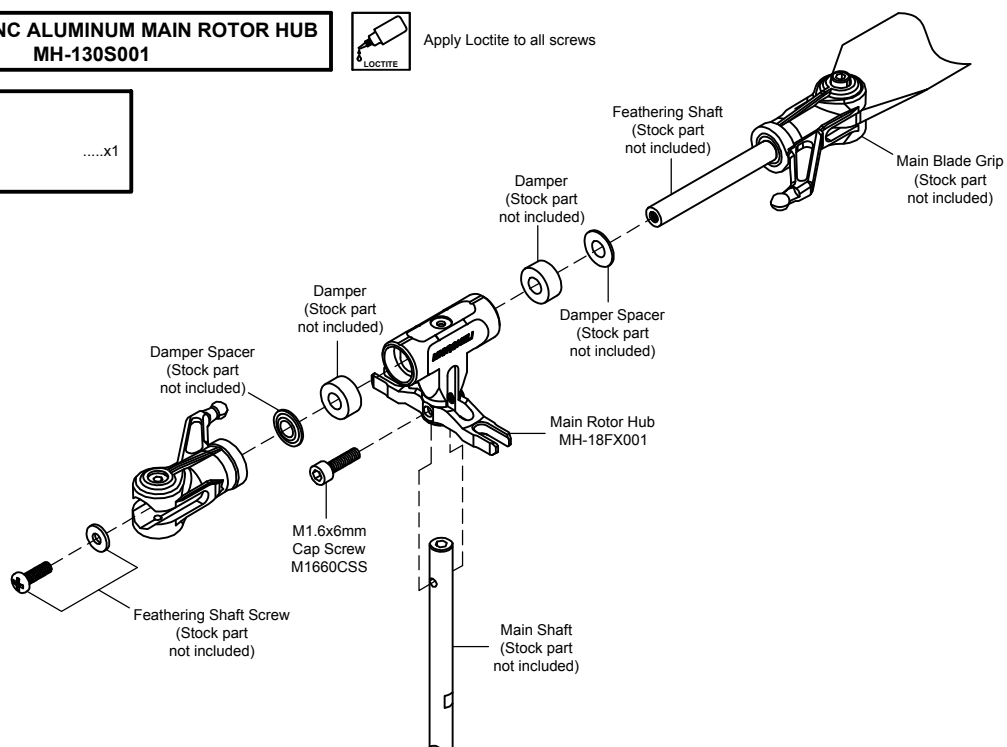

Apply Loctite

CAUTION: Please check your model helicopter carefully before attempt to fly!

REV: 130S001-230817-02

01